

Middlesex Registry of Deeds,  
 Southern District  
 Cambridge, Massachusetts  
 Plan No. 910 (1 OF 2) of 2013  
 Rec'd 11-19 2013  
 at 9 H 31 M A M

Attest

*Thomas P. Bernardi*  
 Register

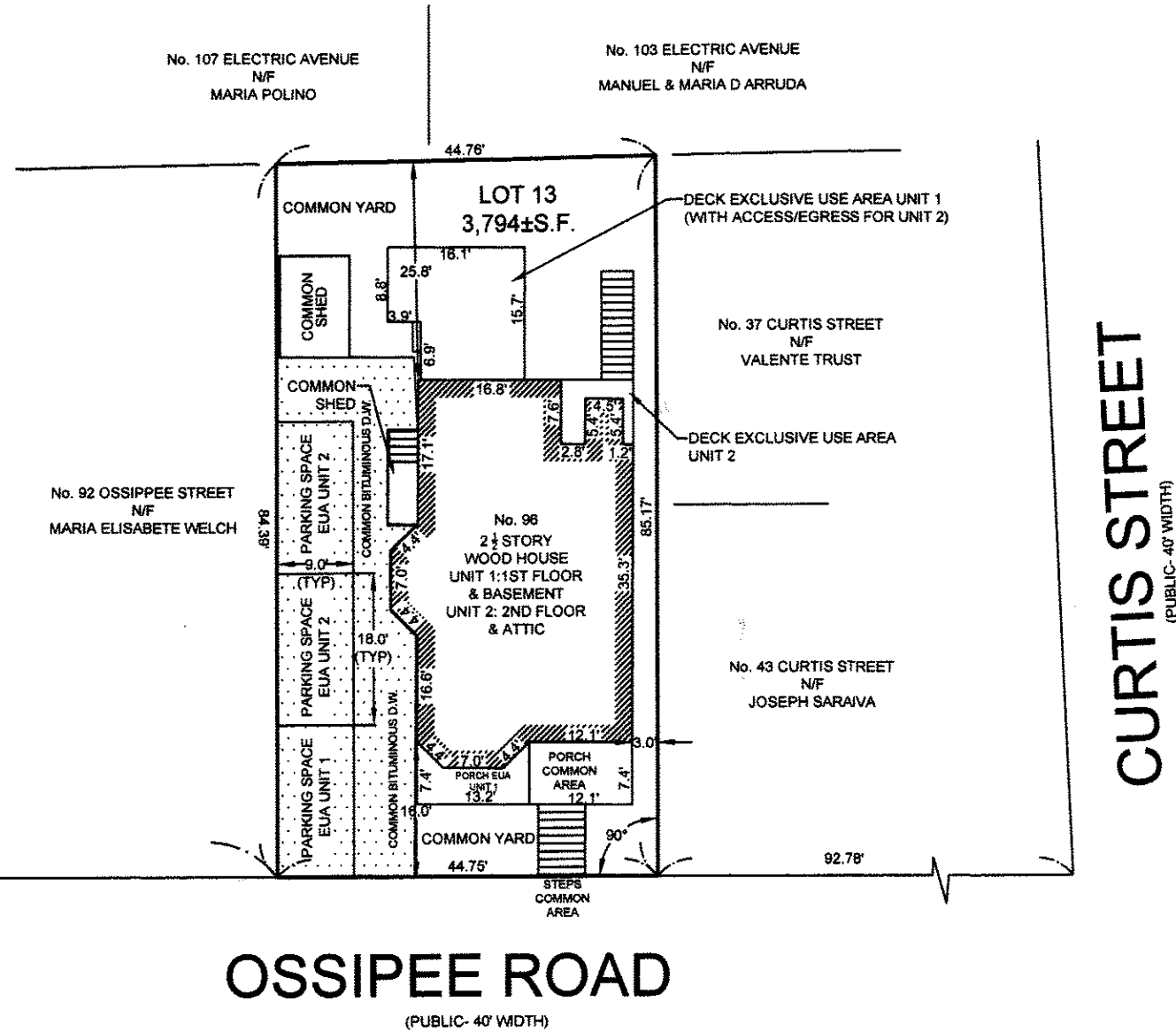
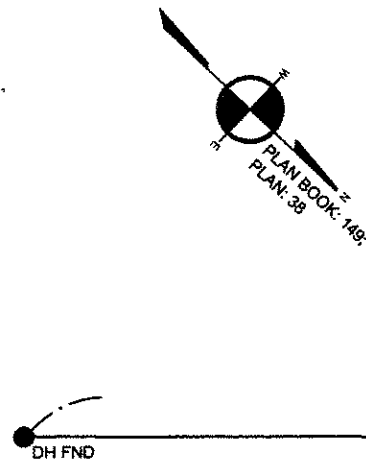

**CERTIFICATION**

I CERTIFY THAT THIS PLAN WAS MADE FROM AN INSTRUMENT SURVEY ON THE GROUND BETWEEN THE DATES OF JUNE 28 AND JUNE 28, 2013 AND ALL STRUCTURES ARE LOCATED AS SHOWN HEREON.

I FURTHER CERTIFY THAT THE BUILDING SHOWN CONFORMED TO THE ZONING LAW OF THE CITY OF SOMERVILLE WHEN CONSTRUCTED.

I HEREBY CERTIFY THAT THE PROPERTY LINES SHOWN ARE LINES DIVIDING EXISTING OWNERSHIPS, AND THE LINES OF STREETS AND WAY SHOWN ARE THOSE OF PUBLIC OR PRIVATE STREETS OR WAYS ALREADY ESTABLISHED, AND THAT NO NEW LINES FOR DIVISION OF EXISTING OWNERSHIPS OR FOR NEW WAYS ARE SHOWN.

I CERTIFY THAT THIS PLAN FULLY AND ACCURATELY DEPICTS THE LOCATIONS AND DIMENSIONS OF THE BUILDINGS AS BUILT AND FULLY LISTS THE UNITS CONTAINED THEREIN, AND FURTHER FULLY AND ACCURATELY DEPICTS, LOCATES AND PROVIDES THE DIMENSIONS OF ALL LIMITED OR EXCLUSIVE USE COMMON AREAS AND FACILITIES OF THE CONDOMINIUM OUTSIDE OF ANY BUILDING.

I HEREBY CERTIFY THAT THIS PLAN WAS PREPARED IN CONFORMITY WITH THE RULES AND REGULATIONS OF THE REGISTERS OF DEEDS OF THE COMMONWEALTH OF MASSACHUSETTS.

THOMAS BERNARDI P.L.S. *TBR* DATE 11-12-13

**REFERENCES**

DEED BOOK: 10680; PAGE: 68  
 PLAN BOOK: 149; PLAN: 38

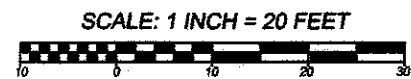

**96 OSSIPEE ROAD CONDOMINIUM**

**SITE PLAN**

**96 OSSIPEE ROAD  
 SOMERVILLE, MA**

PREPARED FOR:  
**KTA CONSTRUCTION LLC**  
 DATE: NOVEMBER 12, 2013







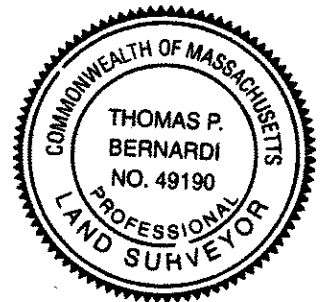

**MASSACHUSETTS  
 SURVEY  
 CONSULTANTS**

10 FIRST AVE SUITE 24  
 PEABODY, MA 01960  
 (617) 899-0703  
 www.MassachusettsSurvey.com

JOB #96 OSSIPEE.DWG



**910 OF 2013 (1 OF 2)**

- LEGEND**
-  DENOTES COMMON AREA
  -  DENOTES EAVE SPACE
  -  DENOTES FURNACE
  -  DENOTES WATER METER
  -  DENOTES ENTRY
  -  DENOTES WINDOW
  -  DENOTES WATER HEATER
  -  DENOTES GAS METER

**FLOOR PLANS**  
FOR UNIT 1 AND UNIT 2  
**"96 OSSIPPEE ROAD CONDOMINIUM"**  
LOCATED AT  
96 OSSIPPEE ROAD  
SOMERVILLE, MA  
DATE: NOVEMBER 12, 2013

I CERTIFY THAT THIS PLAN FULLY AND ACCURATELY DEPICTS THE LAYOUT, LOCATION, UNIT NUMBER AND DIMENSIONS OF THE UNITS NUMBERED 1 & 2 OF THE 96 OSSIPPEE ROAD CONDOMINIUM, AS BUILT. THE BUILDING HAS NO NAME.

I HEREBY CERTIFY THAT THIS PLAN WAS PREPARED IN CONFORMITY WITH THE RULES AND REGULATIONS OF THE REGISTERS OF DEEDS OF THE COMMONWEALTH OF MASSACHUSETTS.

**MASSACHUSETTS  
SURVEY  
CONSULTANTS**

10 1ST AVE STE 24  
PEABODY, MA 01960  
(617) 899-0703  
www.MassachusettsSurvey.com

PLAN NO. 910 OF 2013  
SHEET 2 OF 2

AREAS	
UNIT 1	UNIT 2
BASEMENT: 574 SF±	SECOND FLOOR: 1,054 SF±
FIRST FLOOR: 872 SF±	THIRD FLOOR: 552 SF±
<b>TOTAL: 1,446 SF±</b>	<b>TOTAL: 1,606 SF±</b>

**PREPARED FOR:**  
KTA CONSTRUCTION, LLC  
4 GEMMA DRIVE  
PEABODY, MA 01960

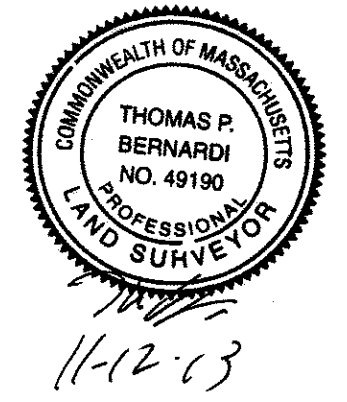
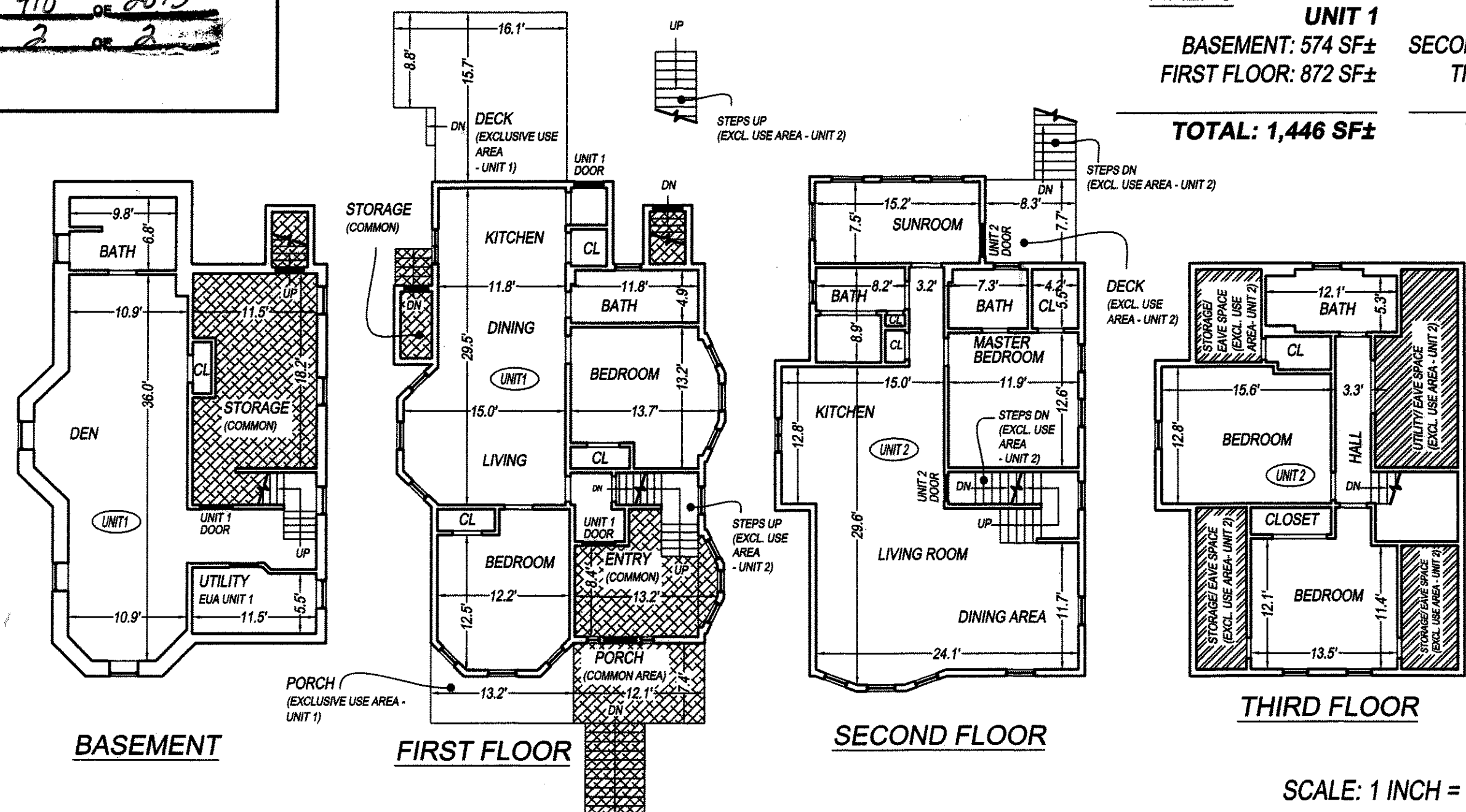

**THIRD FLOOR**

SCALE: 1 INCH = 10 FEET



**910 OF 2013 (2 OF 2)**